

Extension Cable. XC-C8-...F-S1



- Extension cable for absolute linear or angular encoders with digital SSI plus 1 Vpp analog signals output.
- Extension cable XC-C8-F-S1 for:
 - encoder cable EC-...B-C9.
 - angular encoder H2AS...D87...C9.
 - absolute exposed L2AS...C9D.
 to Siemens SMC 20 module.
- Dual shield of the analog signals.
- Twisted pairs for differential signals.
- Available in 5, 10, 15, 20 & 25 meter lengths.
- Low power attenuation and supply voltage sense link.

Pin Out

Pin Input	Colour	Signal	Pin Output
1	Blue	+5 V sense	14
4	White	0 V sense	16
7	Brown-Green	+5 V	1
8	Purple	CLOCK	10
9	Yellow	/CLOCK	12
10	White-Green	0 V	2
12	Blue-Black	B	6
13	Red-Black	/B	7
14	Grey	DATA	15
15	Green-Black	A	3
16	Yellow-Black	/A	4
17	Pink	/DATA	23
11	Internal Shield	Ground	5
Housing	External Shield	Ground	Housing

Pin Layout



Front view

Cable Diagram



L = 5, 10, 15, 20, 25 meters

Pin Layout



Front view

Lead-in Connector

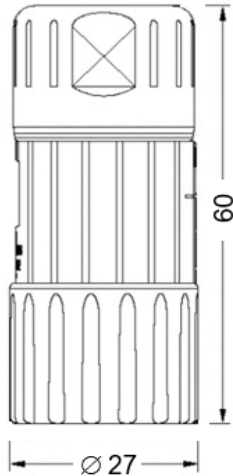

Cable Specification

Construction	4 x 2 x 0.14 mm ² + 4 x 0.5 mm ² + 4 x 0.14 mm ²
Material	Polyurethane
Ø	8 mm
Bend radius dynamic	≥ 80 mm
Bend radius static	≥ 50 mm
Shield	Single plus dual for 4 wires
Lead-in connector (encoder side)	M23 17-pin female, external female, contact arrangement direction P
Terminating connector	D-Sub 25 pole female

Terminating Connector

Housing dimensions slightly differ for manufacturers

Terminating Connector

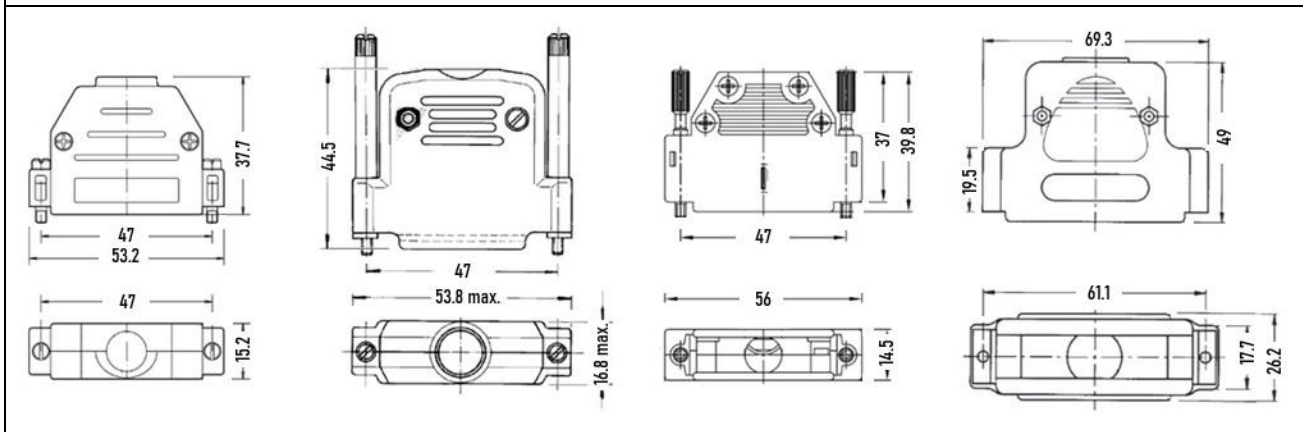

Order Information

XC-C8-(x)F-S1 Where (x) = 5, 10, 15, 20 or 25 meters.

Example

Order Code	Description
XC-C8-10F-S1	Extension cable of 10 meters, specifications as above, lead-in connector M23 17-pin female, external female, contact arrangement direction P. Terminating connector D-Sub 25 pole female.