

DIMENSIONS OF THE SCALE

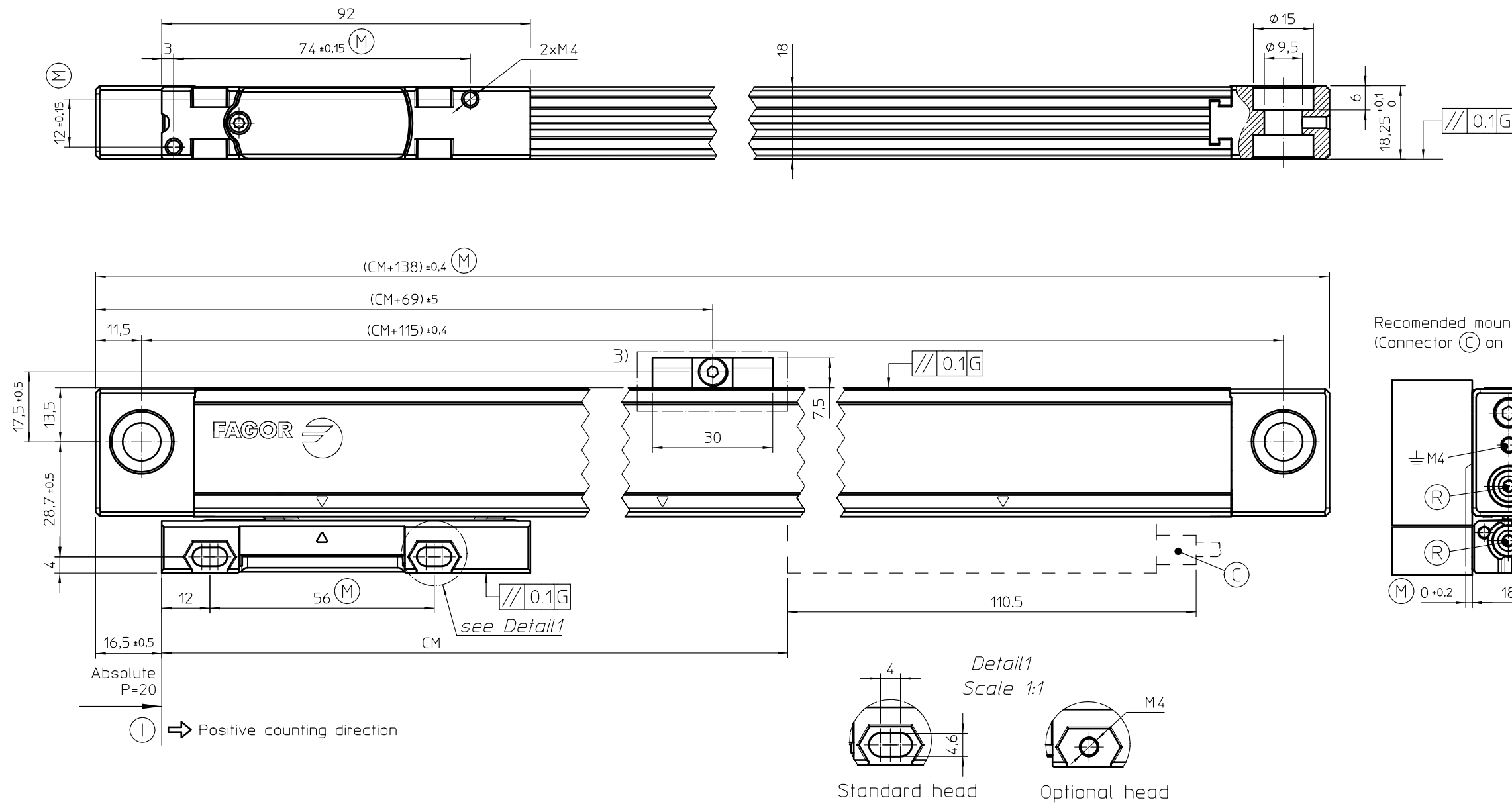

Recommended mounting
(Connector (C) on the right)

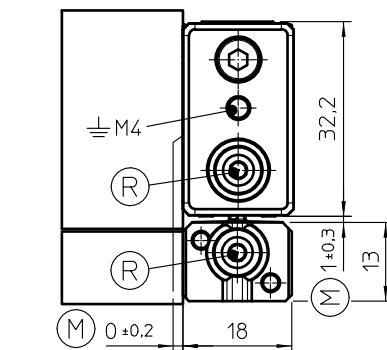

Inverse mounting
(Connector (C) on the left)

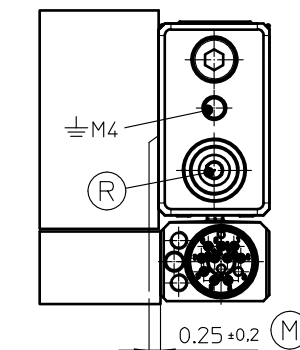

SCALE MOUNTING OPTIONS: HEAD (N1)
STANDARD HEAD

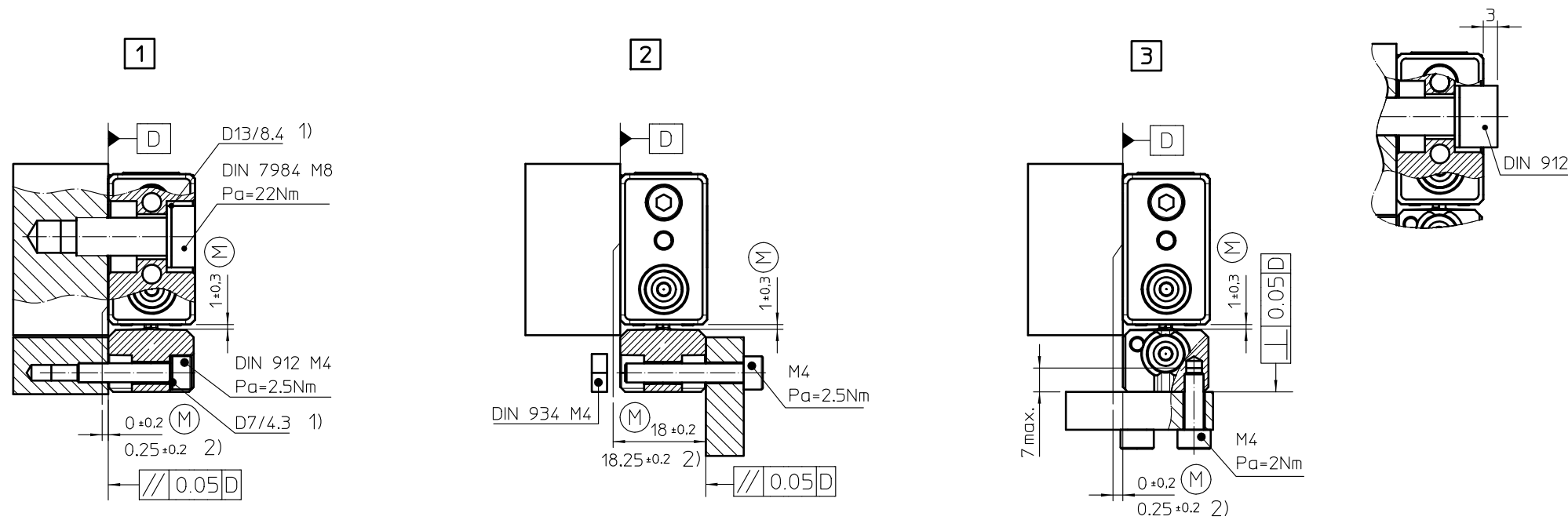

OPTIONAL HEAD

Note: rest of dimensions same as the standard head dimensions

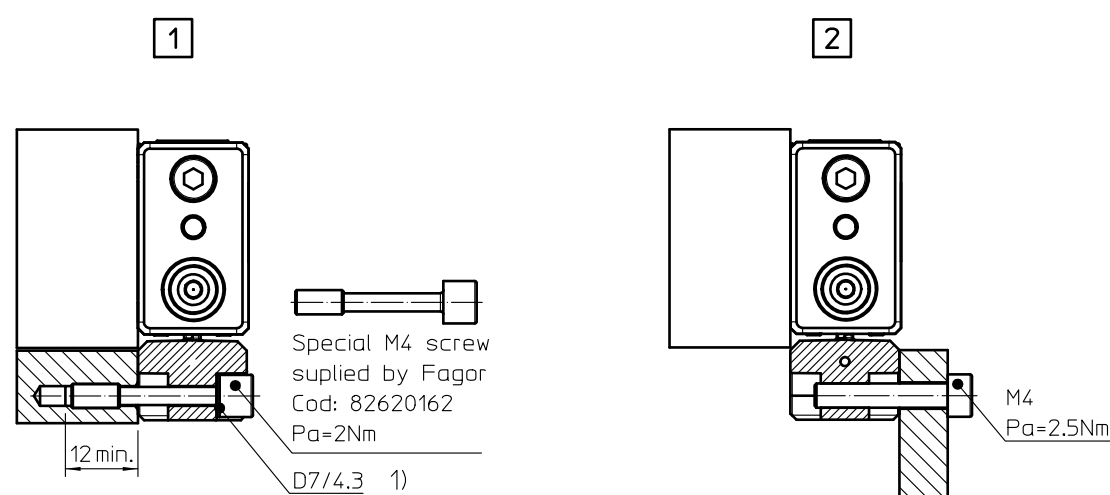

SCALE MOUNTING OPTIONS: SCALE (N1)
ON MACHINED SURFACE

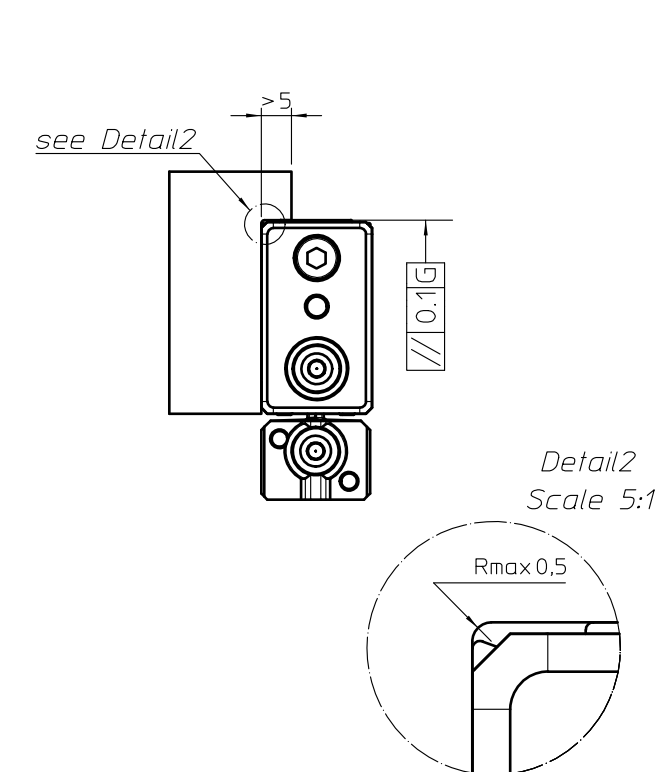

ON PINS

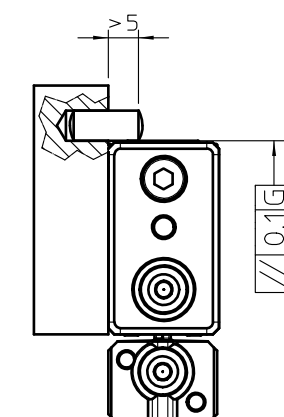

ABBREVIATIONS

- (M) = Assembly sizing set by customer
(C) = Connector can be connected to both sides
(R) = Can connect air intake to both sides
(I) = Beginning of the measuring length
(N1) = Mounting surfaces and threads must be clean and free of paint and grease
CM = Measuring length
G = Machine guideway
Pa = Tightening torque
1) = Items supplied
2) = Measurement for inverse mounting
3) = Intermediate support recommended for large lengths
CM > 620 mm / Cod: 82620171 (included)
CM > 620 mm + Inverse mounting / Cod: 82620177 (not included)

DIFFERENT TYPES OF CONNECTOR CABLES

- (E1) = Three different types of cable
- Cable ϕ 6mm
- Cable ϕ 4mm
- Cable ϕ 10,5mm (with protection)

Bend radius for flexible configuration for:

- Cable ϕ 6mm: R>60mm
- Cable ϕ 4mm: R>40mm
- Cable ϕ 10,5mm: R>60mm

Bend radius for rigid configuration for:

- Cable ϕ 6mm: R>24mm
- Cable ϕ 4mm: R>16mm
- Cable ϕ 10,5mm: R>35mm

(E2) = Cable support

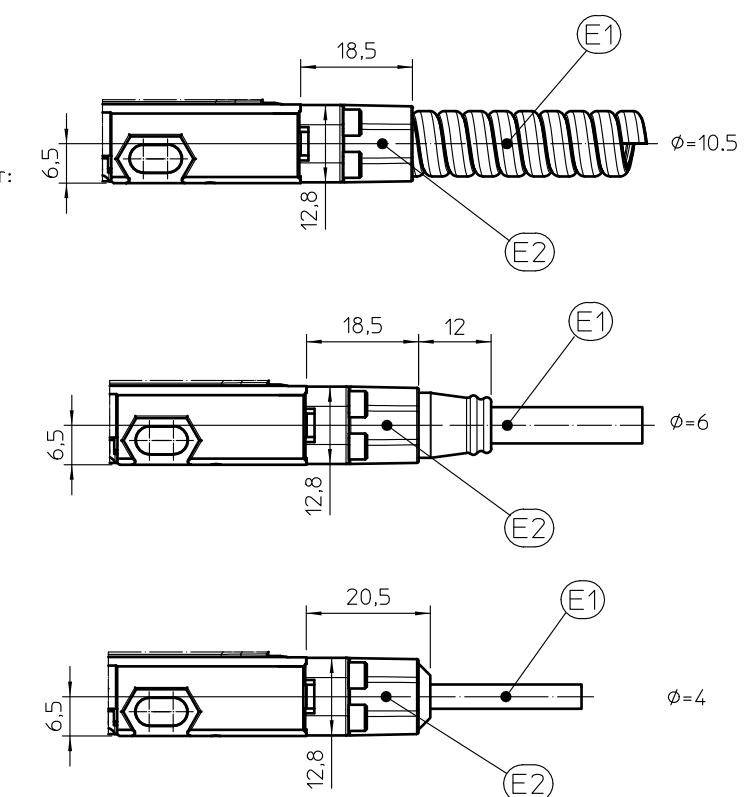

ANNOTATIONS

- 1.- In safety-related applications:
- An anti-rotation lock (medium strength adhesive) is to be used for screws
- A2 class 70 or higher or 8.8 or higher screws must be used.
- Non stainless screws can only be used if the corrosion fault mode is excluded.

					Scale: 1:125	
					Dimensions in mm.	
					Tolerancing ISO 8015 ISO 2768 - m H < 6 mm: ±0.2 mm	
Rev.	Summary			Propo.	App.	Date
	Linear encoder model S3			1		Finish
N°	Designation			Quant.	Material	Treatment
Drawing N		Date		Fagor Automation S. Coop. 20500 Mondragón		
		PT-2-002-1				
Replaces		Design by		Aitor		
		Check by		Zunzu		